

# Cable Connector Class E<sub>A</sub> – 180°, 270° & 360° for 10 GBit Ethernet



# Cable Connector Class E<sub>A</sub>

180°, 270° & 360° – for 10 GBit Ethernet

During maintenance, expansion and installation of new cabling, it's possible for a cable to be too short. What to do? Replacement of the entire cable will cause additional work and increase cost. Also, certain local conditions may not allow this.

The Class E<sub>A</sub> cable connector is the intelligent solution for a simple extension or connecting of data cable without the need for special tools. Thanks to its compact design and the angled variants, it can be used in a wide variety of applications, even in confined spaces. With a Class E<sub>A</sub> compliance, links with up

to 10 GBit/s can be achieved without any problems. The cable connector is therefore a problem solution for almost any network infrastructure, and should be included in every toolbox as basic equipment!



10  
10 GBIT/s



INTELLIGENT  
CABLE MANAGEMENT

Easy to install connection with  
IDC cutting contacts  
AWG 26/1 – 22/1 and AWG 26/7 – 22/7

Strain relief through inte-  
grated locking clip

Line assignment T568A and T568B  
directly on the loading piece

Compact design  
46.6 x 14.7 x 22.6 mm

robust, one-piece and  
reusable zinc die-cast housing

Shield clamp for a  
360° shielding

Same loading piece  
as C6<sub>A</sub>modul



ONLY THREE  
PARTS



EASY ASSEMBLY  
WITHOUT SPECIAL TOOLS

## Variants

Cable Connector Class E<sub>A</sub> 180°

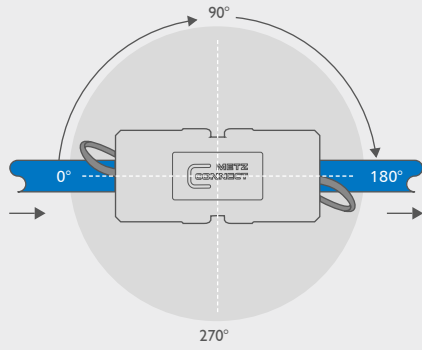

Cable Connector Class E<sub>A</sub> 270°

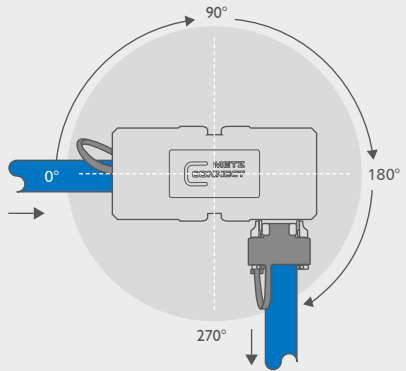

Cable Connector Class E<sub>A</sub> 360°

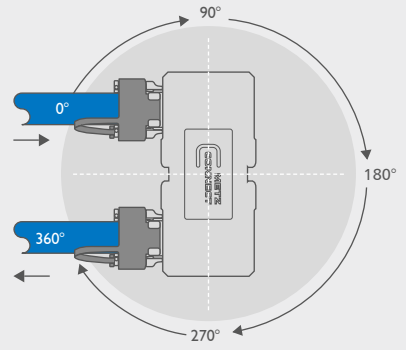

## Application examples

### Infrastructure relocation

e.g. workstation or network distribution cabinet

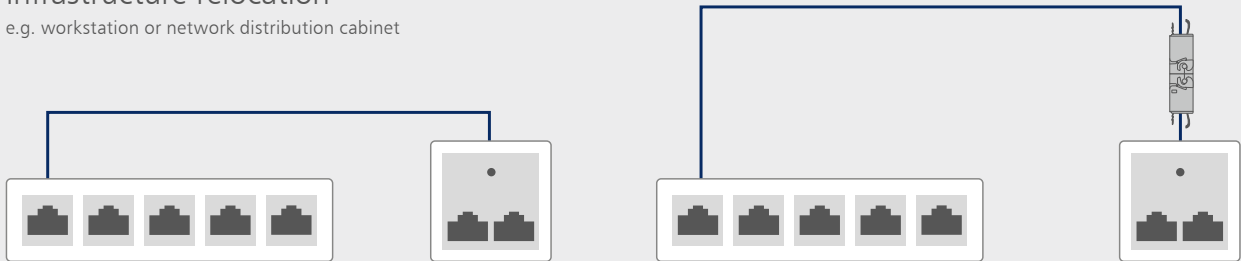

### Cable extension

e.g. cable too short

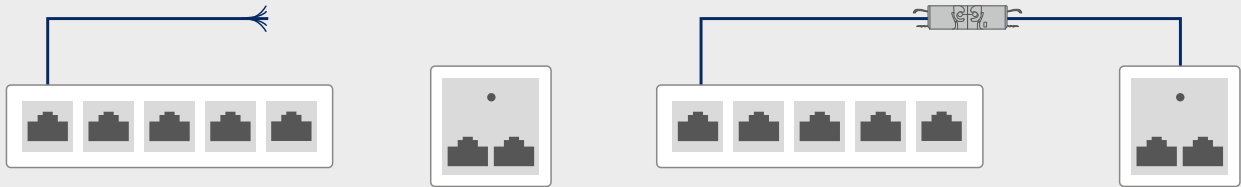

### Repair

e.g. defective cable

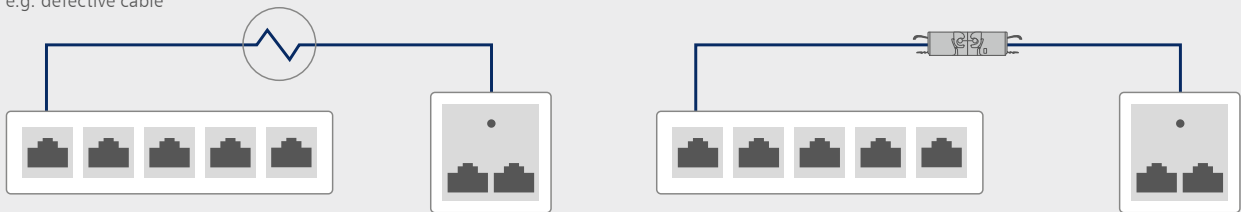

### Reduction of the cable diameter

e. g. too rigid, fixed cable

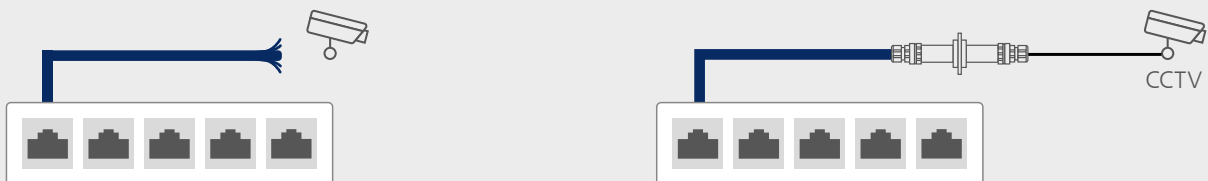

## Relocation of existing infrastructure with C6<sub>A</sub>modul

If the C6<sub>A</sub>modul was used in an existing infrastructure, a relocation can be performed more easily and quickly since the loading piece of the C6<sub>A</sub>modul can be used in the Class E<sub>A</sub> cable connector. Through this, only one side has to be connected again.

### 1 C6<sub>A</sub>modul disassembly

Remove loading piece from the C6<sub>A</sub>modul

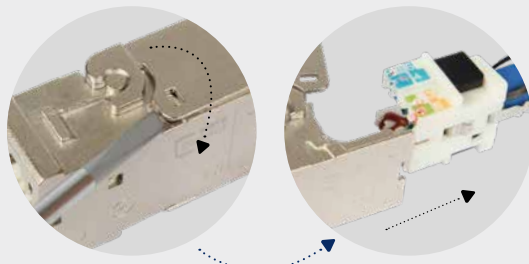

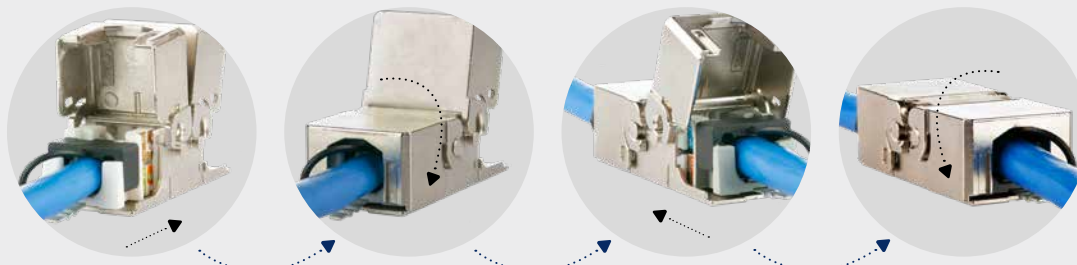

### 2 Mounting of the cable connector Class E<sub>A</sub>

Insert the loading piece into the cable connector and close



## Product overview

	PRODUCT NAME	VARIANT	P/N
	Cable Connector Class E <sub>A</sub>	180°	130863-04-E
	Cable Connector Class E <sub>A</sub>	270°	130863-05-E
	Cable Connector Class E <sub>A</sub>	360°	130863-06-E

# Click & fix

## 19 inches carrier for cable connector

19 inches cable connector bracket for use as a consolidation point, for moving distributors or complete distribution cabinets.

19 inches carrier for mounting  
in the distribution cabinet



Up to 24 cable connectors

Suitable for METZ CONNECT  
Cable connectors

- > Class F<sub>A</sub> P/N 130863-02-E
- > Class E<sub>A</sub> P/N 180°/130863-04-E
- > Class E<sub>A</sub> P/N 360°/130863-06-E

One height unit



Quick mounting



Simple cable management  
with click/lock principle

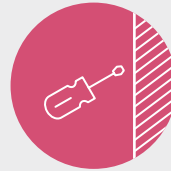

Suitable for a direct  
wall mounting

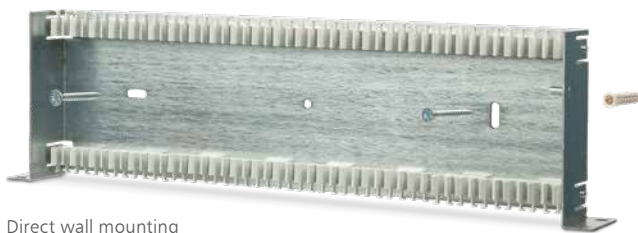
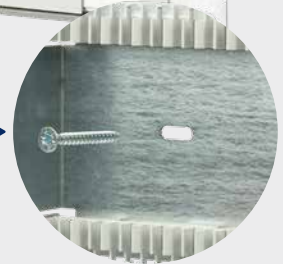

Direct wall mounting

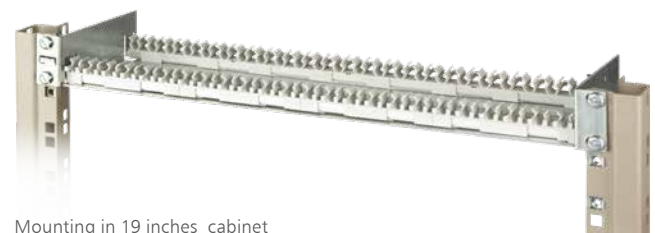

Mounting in 19 inches cabinet

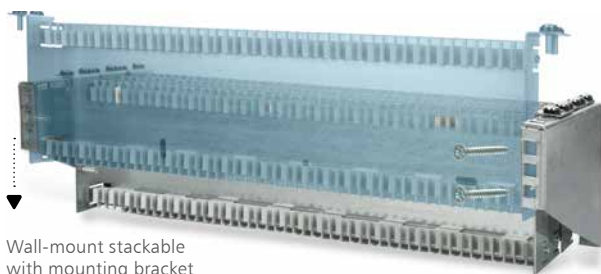

Wall-mount stackable  
with mounting bracket



Wall mounting in 19 inches surface mount housing  
1 or 2HU

130862-1H20-E  
130862-2H20-E

## Application possibilities for cable connectors with and without 19 inches carrier in different cable outlet directions

19 inches cabinet

Wall mounting

Free laying  
Cable tray and cable duct

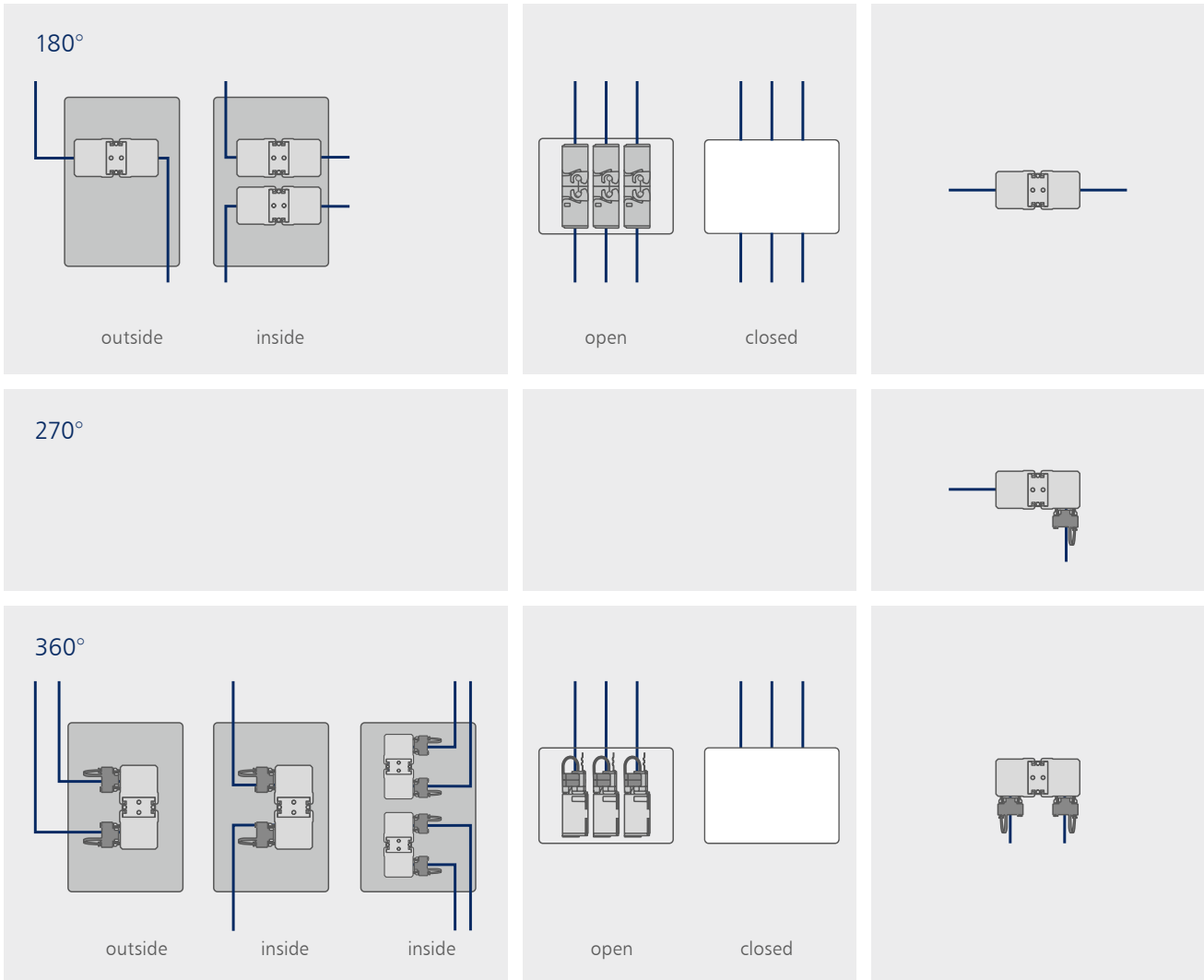

## Product overview

	PRODUCT NAME	VARIANT	P/N
	Click & fix 19 inches carrier for cable connector	1.0HU	130863T101E



We realize ideas

**METZ CONNECT GmbH**

Im Tal 2  
78176 Blumberg  
Germany

Phone +49 7702 533-0  
Fax +49 7702 533-189

info@metz-connect.com  
www.metz-connect.com

**METZ CONNECT USA Inc.**

200 Tornillo Way  
Tinton Falls, NJ 07712  
USA

Phone +1-732-389-1300  
Fax +1-732-389-9066

**METZ CONNECT France SAS**

28, Rue Schweighaeuser  
67000 Strasbourg  
France

Phone +33 3886 17073  
Fax +33 3886 19473

**METZ CONNECT AUSTRIA GmbH**  
c/o German chamber of commerce  
in Austria

Schwarzenbergplatz 5, Top 3/1  
1030 Vienna  
Austria

Phone +43 1 227 12 64  
Fax +43 1 227 12 66

**METZ CONNECT Zhongshan Ltd.**

Ping Chang Road  
Ping Pu Industrial Park  
Sanxiang Town  
Zhongshan City, 528463  
Guangdong Province  
China

Phone +86 760 86365 055  
Fax +86 760 86365 050

**METZ CONNECT Asia Pacific Ltd.**

Suite 1803, 18/F  
Chinachem Hollywood Centre,  
1 Hollywood Road, Central  
Hong Kong

Phone +852 26 027 300  
Fax +852 27 257 522

